

# EXHIBIT 9

## (KEURIG 2.0 K400 SERIES USER'S GUIDE)

GUIDE | GUIDE | GUÍA



## IMPORTANT SAFEGUARDS

When using electrical appliances, basic safety precautions should be followed, including the following:

1. Read all instructions before using.
2. Do not touch hot surfaces. Use handles and knobs when available.
3. This appliance must be properly installed and located in accordance with these instructions before it is used.
4. The use of accessory attachments not recommended by the appliance manufacturer may result in fire, electrical shock or injury to persons.
5. Do not place on or near a hot gas or electric burner, or in a heated oven.
6. Do not use outdoors.
7. To protect against fire, electric shock and injury do not immerse cords, plugs or the appliance in water or any other liquid.
8. Do not fill the Water Reservoir above the MAX FILL line.
9. **Use only water in this appliance!** Do not put any other liquids or foods in the Water Reservoir except as instructed in the cleaning instructions in this guide.
10. Turn off and unplug the brewer before cleaning or maintenance. Allow to cool before putting on or taking off parts and before cleaning the appliance.
11. For best operation, plug the appliance into its own electrical outlet on a dedicated circuit to prevent flickering of lights, blowing of fuses or tripping a circuit breaker.
12. Do not operate any appliance with a damaged Power Cord or plug or after the appliance malfunctions or is damaged in any manner. Contact Keurig Customer Service to report any malfunction of or damage to the brewer.
13. Do not let the Power Cord hang over the edge of the table or counter, or touch hot surfaces.
14. To disconnect, press the Power Button on the brewer to "OFF" status and then remove the plug from the wall outlet.
15. Close supervision is necessary when any appliance is used by or near children.
16. **Do not lift the brewer Handle while brewing is in progress.**

17. Always keep the Flip-Top Reservoir Lid on the Water Reservoir unless you are refilling it.
18. This appliance is equipped with a Power Cord having a grounding wire with a grounding plug. The appliance must be grounded using a 3-hole properly grounded outlet. In the event of an electrical short circuit, grounding reduces the risk of electrical shock.
19. If the outlet is a standard 2-prong wall outlet, it is your personal responsibility and obligation to have it replaced with a properly grounded 3-prong wall outlet.
20. Do not, under any circumstances, cut or remove the third (ground) prong from the Power Cord or use an adapter.
21. Consult a qualified electrician if the grounding instructions are not completely understood, or if doubt exists as to whether the appliance is properly grounded.
22. Do not use the appliance for other than its intended use.
23. Remove the shipping disk before brewing.

## SAVE THESE INSTRUCTIONS.

### WARNING TO USERS AND PARENTS:

1. **DO NOT** permit children to use the brewer unless there is adult supervision. Brewer dispenses very hot water.
2. **SPECIAL NOTICE FOR HOT COCOA/OTHER USERS: IMMEDIATELY AFTER USING A HOT COCOA/OTHER PACK, RUN A HOT WATER BREW CYCLE** without a pack to avoid the possibility of clogging the exit needle. **DO NOT** assume the next user will do this.

### WARNING

RISK OF FIRE OR  
ELECTRIC SHOCK



DO NOT OPEN



WARNING: TO REDUCE THE RISK OF FIRE OR ELECTRIC SHOCK, DO NOT REMOVE THE BOTTOM COVER. NO USER SERVICEABLE PARTS ARE INSIDE. REPAIR SHOULD BE DONE BY AUTHORIZED SERVICE PERSONNEL ONLY.

**CAUTION:** There are three sharp needles that puncture packs, two above the Pack Holder and the other in the bottom of the Pack Holder. To avoid risk of injury, do not put your fingers in the Pack Holder Assembly.

**CAUTION:** There is extremely hot water in the Pack Holder during the brew process. To avoid risk of injury, do not lift the Handle or open the Pack Holder Assembly during the brewing process.

**CAUTION:** Do not fill above the MAX FILL line. If you fill the Water Reservoir above this point, you may occasionally get a larger brew than you selected for your first brew of the day. If you prefer to have your Water Reservoir filled to the top, we recommend you use a large mug for your first brew of the day to avoid any risk of overflow.

**CAUTION:** Please always keep the brewer in its upright position to avoid potential injury and/or damage to your brewer.

**CAUTION:** Very hot liquid. Adult supervision required.

**SHORT CORD INSTRUCTIONS:**

A short power supply cord is provided to reduce the risk of becoming entangled in or tripping over a longer cord.

Longer detachable power-supply cords or extension cords are available and may be used if care is exercised in their use. If an extension cord is used, (1) the marked electrical rating of the cord set or extension cord should be at least as great as the electrical rating of the appliance; (2) the cord should be arranged so that it will not drape over the countertop or tabletop where it can be pulled on by children or tripped over unintentionally; and (3) the extension cord must include a 3-prong grounding plug.

**Your Keurig® 2.0 brewer will not work with packs that do not have the Keurig® logo on them.**

**Keurig® 2.0 brewers are not compatible with the My K-Cup® reusable filter accessory.**

**THIS PRODUCT IS FOR HOUSEHOLD USE ONLY.**

## **WARNING**

**THIS PRODUCT CONTAINS CHEMICALS, INCLUDING LEAD, WHICH IS KNOWN TO THE STATE OF CALIFORNIA TO CAUSE CANCER, BIRTH DEFECTS OR OTHER REPRODUCTIVE HARM.**

**TABLE OF CONTENTS**  
**KEURIG® 2.0 BREWING SYSTEM | K2.0-400 SERIES BREWER**

Features	6
Touchscreen Controls	7
<b>SECTION 1</b>	
Set-Up & Cleansing Brew	8
Brew Your First K-Cup® Pack	10
Brew Your First K-Carafe™ Pack	11
Set Carafe Auto Brew Mode	12
<b>SECTION 2</b>	
Stopping the Brew Process	14
Adding Water	14
Dispensing Hot Water into a Mug	15
Adding a Favorite	16
Editing a Favorite	17
Using a Favorite	17
Settings Menu	18
Caring For Your Brewer	22
Maintenance Alerts	28
Recycling K-Carafe™ Packs	31
<b>SECTION 3</b>	
Troubleshooting	32
<b>SECTION 4</b>	
Warranty	34

## FEATURES



### K2.0-400 SERIES BREWER

- |                             |                    |   |
|-----------------------------|--------------------|---|
| A. Flip-Top Reservoir Lid   | F. Handle          | K. Pack Holder                                    |
| B. Water Reservoir          | G. Brew Head       | L. Housing (K and L are the Pack Holder Assembly) |
| C. Top Housing              | H. Power Cord      | M. Base   |
| D. Touchscreen/Power Button | I. Drip Tray Plate | N. Keurig™ Carafe                                 |
| E. Brew Button              | J. Drip Tray       |   |

## TOUCHSCREEN CONTROLS

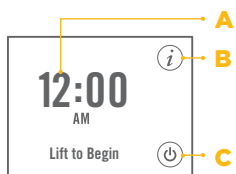

**HOME SCREEN**

- A. Clock
- B. Settings Button
- C. Power Button

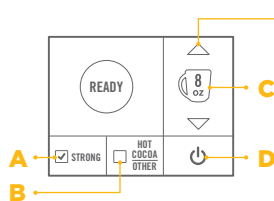

**SCREEN FOR K-CUP® PACKS**

- A. STRONG  
(only available for coffee)
- B. HOT COCOA/OTHER  
(for select non-coffee beverages)
- C. Brew Size
- D. Power Button

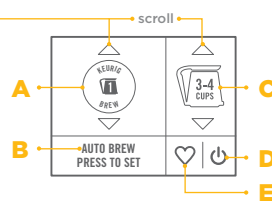

**SCREEN FOR K-CARAFE™ PACKS**

- A. KEURIG BREW®  
Setting 1
- B. AUTO BREW  
(only available for K-Carafe™ packs)
- C. Brew Size
- D. Power Button
- E. Favorites Button

## BREW SETTINGS (OUTLINE INDICATES DEFAULT SIZE)

K-CUP® PACKS	K-CARAFE™ PACKS	FUTURE KEURIG® BRAND PACKS					
<p>READY</p> <p>4 oz</p> <p>6 oz</p> <p>8 oz</p> <p>10 oz</p>	<p>1</p> <p>2-3 CUPS</p> <p>3-4 CUPS</p> <p>4-5 CUPS</p>	<p>2</p> <p>12 oz</p> <p>14 oz</p>	<p>3</p> <p>12 oz</p> <p>14 oz</p>	<p>4</p> <p>4.4 oz</p> <p>6 oz</p> <p>8 oz</p>	<p>5</p> <p>STEP 1 FROTH</p> <p>4.4 oz</p> <p>STEP 2 FROTH</p> <p>4.4 oz</p>	<p>6</p> <p>6 oz</p> <p>8 oz</p> <p>10 oz</p>	<p>1 2 3</p> <p>4 5 6</p> <p>Select Brew Setting</p> <p>KEURIG BREW® SETTING SELECTION SCREEN</p> <p>Select the KEURIG BREW® Setting that matches the number on the pack lid.</p>



## SET-UP & CLEANSING BREW

### SET-UP

1. Place the brewer on a counter and plug into a grounded outlet.

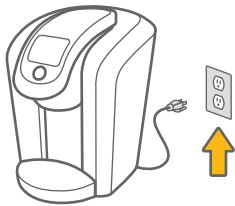

2. Lift the Handle, remove and discard the shipping disk.

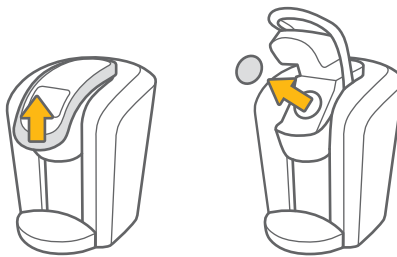

3. Rinse the Water Reservoir, fill with bottled or filtered water, and return it to the brewer.

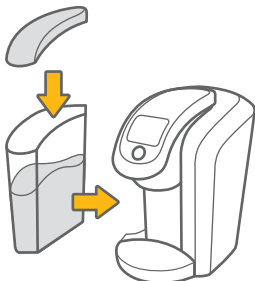

4. Press the Power Button and wait for preheating to complete, about three minutes.

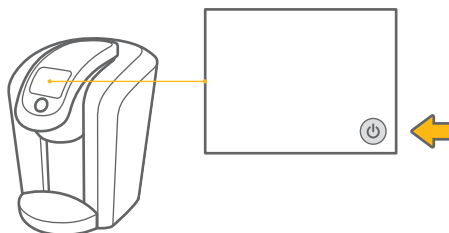

SECTION 1

**CLEANSING BREW**

1. To begin a cleansing brew, place a 12 ounce mug on the Drip Tray.



2. Lift and lower the Handle. Do not place a Keurig® brand pack in the Pack Holder.

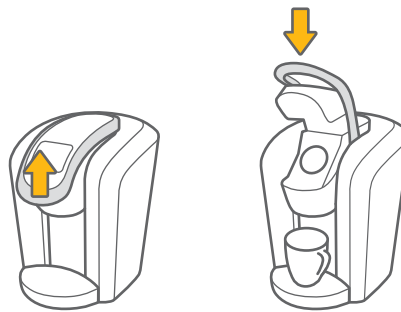

3. Select a 6 ounce Brew Size and press the Brew Button.



4. You are now ready to use your brewer!



## Getting Started with Docket Alarm

### Search, Track, and Analyze cases on PACER, the ITC, the PTAB, and State Courts

**Comprehensive Search:** Over 170 million cases, including PACER, state courts, the Supreme Court, ITC, TTAB, PTAB and trademark prosecution history.

**Real-Time Alerts:** Never check the court docket again. We integrate with ECF systems so you get alerts and documents immediately.

**Powerful Analytics:** Our case predictor can tell you the likelihood of winning by judge, firm, or party. See a firm's clients or a party's outside counsel.

### Benefits

**Combine Services:** Docket Alarm does the work of multiple services in one package.

**Uber-Fast:** Search with speed. Alerts up to 16 times a day to get filings in real-time.

**Search You Know:** Support for both terms and connectors and natural language searching.

**Bulk Downloads:** Download hundreds of filings in seconds.

**Reports:** Easily export reports from your research.

**API:** Integrate our data into your app with our API.

**User Friendly:** Our service is beautiful and, yes, fun to use.

#### Some of Our Clients

GOODWIN  
PROCTER

ORRICK

ROPES  
& GRAY

Paul|Weiss